

SYMBOL	REVISION REQUIRED	DATE	AUTH.
A	Redrawn, revised notes, mounting holes were # 31 drill	12/27/2007	D.B.O.
B	Updated and revised notes	9/15/2015	D.B.O.

Notes:

1. All dimensions are in inches.
2. Sensitivity: 35 minutes per 0.1" movement of bubble.
When bubble is completely outside the centering circle, the level is 2° out of level. Tolerance on sensitivity is ± 10%.
3. Fluid: Clear Mineral Spirits
4. Level is waterproofed
5. Temperature Requirements: - 40° F to + 135° F

5. Material: Housing: Brass
Vial: Glass
7. Finish on Housing: Chrome Plate
NOTE: Part or all of the finish maybe removed from Surface "X" during calibration.

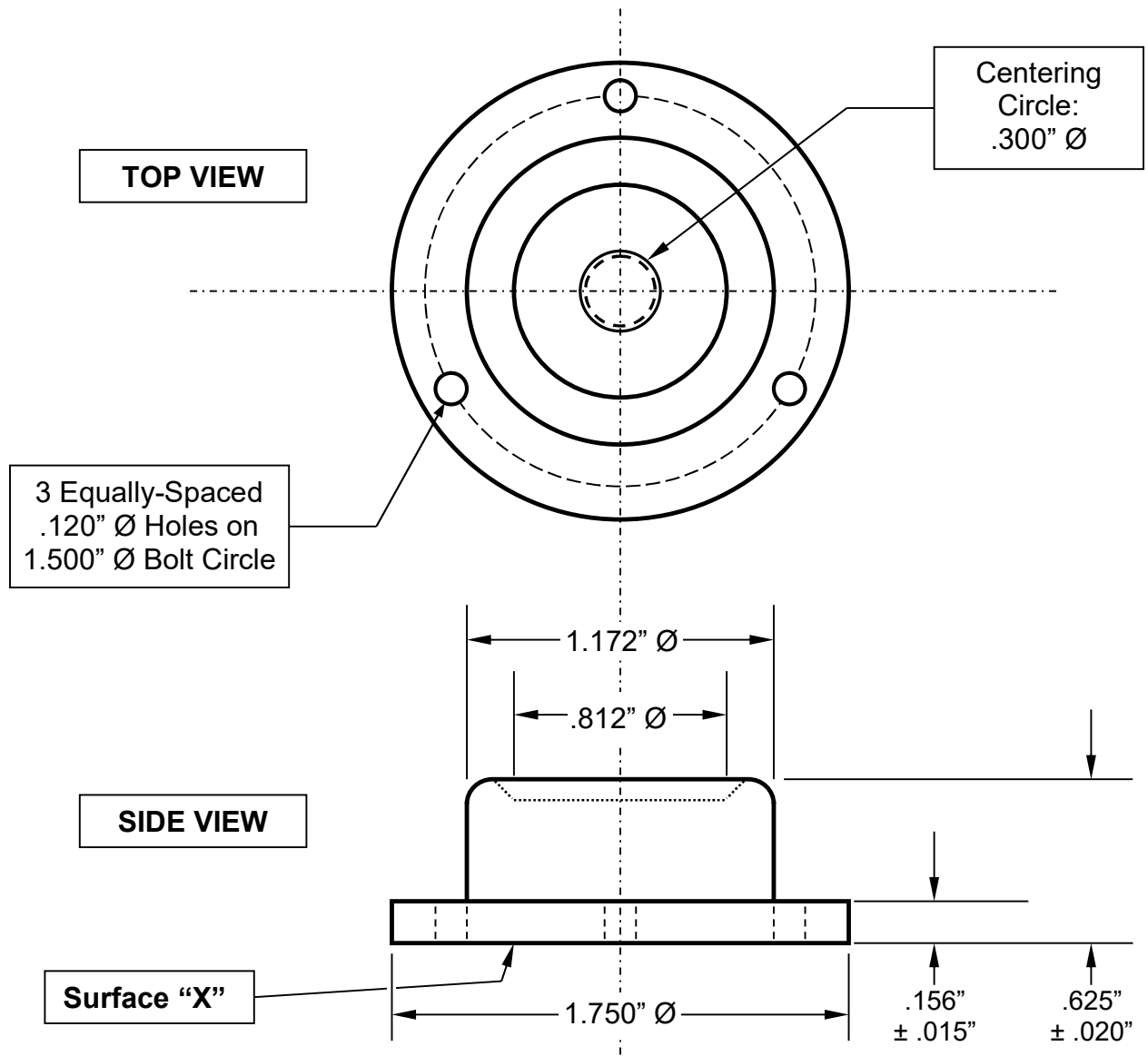

Tolerances: (except as noted)	Decimal ± .010"	Fractional ± 1/64"	Angular ± 1°
GEIER & BLUHM Division of HJM Precision, Inc. 9 New Turnpike Road Troy, NY 12182 USA	DRAWN BY: David Oster		DATE: February 7, 2003
	Scale: NONE		DRAWING NUMBER
	MOUNTED CIRCULAR LEVEL		2-16061