

SYMBOL	REVISION REQUIRED	DATE	AUTH.
A	Add Tolerances & Notes	10/1963	H.F.O.
B	Redrawn	8/25/2004	D.B.O.
C	Redrawn, revised notes	1/23/2007	D.B.O.
D	Centering Circle was .220" Ø	4/6/2009	D.B.O.

- Notes:**
1. All Dimensions in inches
 2. SENSITIVITY: 45 minutes / .1" movement of the bubble
Tolerance on sensitivity is +/- 10%.
 3. Part or all of the finish maybe removed from Surface "X" during calibration
 4. Centering circle and cross-lines are baked-on paint

MATERIAL: Housing: Brass
Vial: Glass

FINISH on Housing: Chrome Plate

FLUID: Mineral Spirits

COLOR of FLUID: Clear

TOLERANCES: Decimal: $\pm .010''$
Fractional: $\pm 1/64''$
Angular: $\pm 1^\circ$

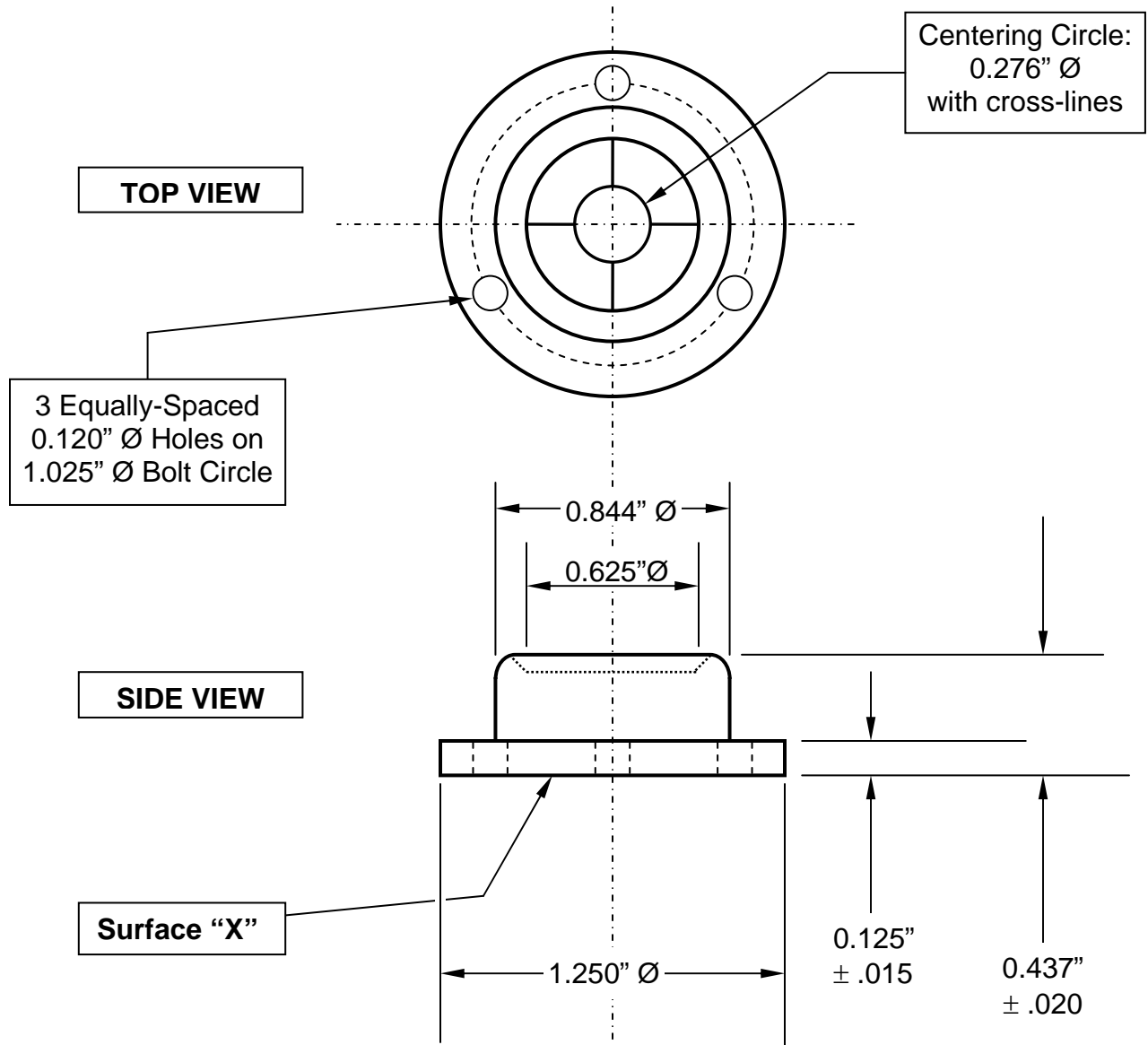

GEIER & BLUHM, INC.
594 River Street
Troy, NY 12180
USA

DRAWN BY: DAVID OSTER

Scale: NONE

**MOUNTED
CIRCULAR LEVEL**

DATE: December 17, 1959

DRAWING NUMBER

2-12020